

PROJECT NO.	SHEET NO.	TOTAL NO.
2022CPT.11.21.20032	1	2
2022CPT.11.21.20862		
2022CPT.11.21.20992		

SUMMARY OF QUANTITIES

PROJECT NO.	COUNTY	MAP NO.	ROUTE	ROUTE NAME	FROM DESCRIPTION	TO DESCRIPTION	MILE POST FROM	MILE POST TO	TYP NO.	LANES	LANE TYPE	LENGTH	WIDTH	1839000000-E	1836000000-E	1838000000-E	1838500000-N	2143000000-E	4413000000-E	4457000000-N		
														ASPHALT SURFACE TREATMENT, CAPE SEAL	ASPHALT SURFACE TREATMENT, TRIPLE SEAL	EMULSION FOR ASPHALT SURFACE TREATMENT	VACUUM TRUCK	BLOTTING SAND	WORK ZONE ADVANCE/GENERAL WARNING SIGNING	TEMPORARY TRAFFIC CONTROL		
														SY	SY	GAL	WK	TON	SF	LS		
2022CPT.11.21.20032	Allegheny	1	SR 1103	Camp Cheerio Rd	SR 1105	EOM	1.17	2.44	1	2	2WU	1.27	18			13,411	10,595	5	500	165	1	
2022CPT.11.21.20032	Allegheny	2	SR 1104	Camp Butler Rd	SR 1103	SR 1181	0.00	0.36	1	2	2WU	0.36	20			4,224	3,337			47		
2022CPT.11.21.20032	Allegheny	3	SR 1104	Camp Butler Rd	SR 1181	DE	0.36	1.17	1	2	2WU	0.81	16			7,603	6,007			105		
2022CPT.11.21.20032	Allegheny	4	SR 1105	Camp Butler Rd	SR 1103	US 21	0.00	0.51	1	2	2WU	0.51	18			5,386	4,255			66		
2022CPT.11.21.20032	Allegheny	5	SR 1106	Cherry Lane Rd	US 21	US 21	0.00	1.70	1	2	2WU	1.7	18			17,952	14,182			221		
2022CPT.11.21.20032	Allegheny	6	SR 1107	Foxfire Rd	US 21	US 21	0.00	0.43	1	2	2WU	0.432	12			3,041	2,403			56		
2022CPT.11.21.20032	Allegheny	7	SR 1108	Rash Rd	SR 1106	BRP	0.00	1.17	1	2	2WU	1.17	18			12,355	9,761			152		
2022CPT.11.21.20032	Allegheny	8	SR 1109	Vestal Rd	SR 1108	BRP	0.00	0.65	1	2	2WU	0.65	18			6,864	5,423			85		
2022CPT.11.21.20032	Allegheny	9	SR 1111	Pull Tail Rd	US 21	MP 1.06/Pavement Width Change	0.00	1.06	1	2	2WU	1.06	20			12,437	9,825			138		
2022CPT.11.21.20032	Allegheny	10	SR 1111	Pull Tail Rd	MP 1.06/Pavement Width Change	BRP	1.06	1.70	1	2	2WU	0.64	16			6,007	4,746			83		
2022CPT.11.21.20032	Allegheny	11	SR 1112	Araniska Rd	SR 1111	Cul De Sac	0.00	0.35	1	2	2WU	0.35	18			3,696	2,920			46		
2022CPT.11.21.20032	Allegheny	12	SR 1118	Tedder Rd	SR 1114	SR 1121	2.42	3.04	1	2	2WU	0.62	20			7,275	5,747			81		
2022CPT.11.21.20032	Allegheny	13	SR 1181	McKinney Rd	SR 1104	DE	0.00	0.74	1	2	2WU	0.74	18			7,814	6,173			96		
2022CPT.11.21.20032	Allegheny	14	SR 1342	Farmers Fish Camp rd	VA LINE	SR 1345	0.00	1.32	1	2	2WU	1.32	18			13,939	11,012			172		
2022CPT.11.21.20032	Allegheny	15	SR 1343	Gambill Rd	SR 1342	DE	0.00	0.10	1	2	2WU	0.10	18			1,056	834			13		
2022CPT.11.21.20032	Allegheny	16	SR 1345	Farmers Fish Camp rd	NC 93	SR01342	0.00	1.74	1	2	2WU	1.74	18			18,374	14,516			226		
2022CPT.11.21.20032	Allegheny	17	SR 1468	Caudill Rd	SR 1464	EOP	0.00	0.40	1	2	2WU	0.40	12			2,816	2,225			52		
2022CPT.11.21.20032	Allegheny	18	SR 1491	Rich Hill Mtn Rd	SR 1463	EOM	0.00	0.41	1	2	2WU	0.41	16			3,849	3,040			53		
TOTAL FOR PROJECT NO. 2022CPT.11.21.20032													14.28		148,100	116,999	5	500	1,857	1		
2022CPT.11.21.20862	Surry	19	SR 1154	Benge Dr	SR 1153	EOM	0.00	0.60	2	2	2WU	0.60	18			6,336	3,485			78		
2022CPT.11.21.20862	Surry	20	SR 1305	Regal Rd	SR 1301	END PVMT	0.00	0.32	1	2	2WU	0.32	16			3,004	2,373			42		
2022CPT.11.21.20862	Surry	21	SR 1320	Wolfe Rd	SR 1301	SR 1319	0.00	1.67	1	2	2WU	1.67	20			19,595	15,480			217		
2022CPT.11.21.20862	Surry	22	SR 1506	Scarlett Ln	SR 1395	CUL-DE-SAC	0.00	0.15	2	2	2WU	0.15	20			1,760	968			20		
2022CPT.11.21.20862	Surry	23	SR 1616	Lowe Rd	SR 1396	EOP	0.00	0.48	2	2	2WU	0.48	20			5,632	3,098			62		
2022CPT.11.21.20862	Surry	24	SR 1934	McCarthy Rd	SR 1786	Cul-De-Sac	0.00	0.19	2	2	2WU	0.19	20			2,229	1,226			25		
2022CPT.11.21.20862	Surry	25	SR 2024	Toms Creek Rd	SR 2022	NC 268	0.00	1.75	1	2	2WU	1.75	20			20,533	16,221			228		
2022CPT.11.21.20862	Surry	26	SR 2049	Dodson Mill Rd	SR 1857	EOM	0.00	1.23	2	2	2WU	1.23	20			14,432	7,938			160		
2022CPT.11.21.20862	Surry	27	SR 2052	Patterson Farm Rd	STOKES CO	CUL-DE-SAC	0.00	0.30	2	2	2WU	0.30	16			2,816	1,549			39		
2022CPT.11.21.20862	Surry	28	SR 2062	Johnny Ayers Rd	SR 2061	EOM	0.00	0.80	1	2	2WU	0.80	20			9,387	7,415			104		
2022CPT.11.21.20862	Surry	29	SR 2063	Culler Rd	SR 2061	EOM	0.00	0.70	1	2	2WU	0.70	20			8,213	6,489			91		
2022CPT.11.21.20862	Surry	30	SR 2067	Grassy Creek Rd	SR 2065	Bridge # 142 over Grassy Creek	0.00	1.64	1	2	2WU	1.64	20			19,243	15,202			213		
2022CPT.11.21.20862	Surry	31	SR 2086	Stanford Ch Rd	SR 2080	NC 268	0.00	2.33	1	2	2WU	2.33	16			21,871	17,278			303		
2022CPT.11.21.20862	Surry	32	SR 2087	Allen Rd	SR 2086	EOM/EOP	0.00	0.70	1	2	2WU	0.70	16			6,571	5,191			91		
2022CPT.11.21.20862	Surry	33	SR 2102	Whitaker Rd	NC 268	EOM	0.00	0.60	2	2	2WU	0.60	20			7,040	3,872			78		
2022CPT.11.21.20862	Surry	34	SR 2109	Windover Dr	NC 268	CUL-DE-SAC	0.00	0.11	2	2	2WU	0.11	20			1,291	710			14		
2022CPT.11.21.20862	Surry	35	SR 2128	Buckingham Rd	SR 2048	SR 2136	0.00	0.20	2	2	2WU	0.20	18			2,112	1,162			26		

PROJECT NO.	SHEET NO.	TOTAL NO.
2022CPT.11.21.20032	2	2
2022CPT.11.21.20862		
2022CPT.11.21.20992		

SUMMARY OF QUANTITIES

PROJECT NO.	COUNTY	MAP NO.	ROUTE	ROUTE NAME	FROM DESCRIPTION	TO DESCRIPTION	MILE POST FROM	MILE POST TO	TYP NO.	LANES	LANE TYPE	LENGTH	WIDTH	1839000000-E	1836000000-E	1838000000-E	1838500000-N	2143000000-E	4413000000-E	4457000000-N
														ASPHALT SURFACE TREATMENT, CAPE SEAL	ASPHALT SURFACE TREATMENT, TRIPLE SEAL	EMULSION FOR ASPHALT SURFACE TREATMENT	VACUUM TRUCK	BLOTTING SAND	WORK ZONE ADVANCE/GENERAL WARNING SIGNING	TEMPORARY TRAFFIC CONTROL
														SY	SY	GAL	WK	TON	SF	LS
2022CPT.11.21.20862	Surry	36	SR 2129	N Kingston St	SR 2128	EOM	0.00	0.12	2	2	2WU	0.12	18	1,267		697			16	
2022CPT.11.21.20862	Surry	37	SR 2130	Queen St	SR 2129	CUL-DE-SAC	0.00	0.11	2	2	2WU	0.11	16	1,033		568			14	
2022CPT.11.21.20862	Surry	38	SR 2131	S Kingston St	SR 2128	CUL-DE-SAC	0.00	0.09	2	2	2WU	0.09	20	1,056		581			12	
2022CPT.11.21.20862	Surry	39	SR 2136	Fairfax Dr	SR 2128	CUL-DE-SAC	0.00	0.16	2	2	2WU	0.16	18	1,690		929			21	
2022CPT.11.21.20862	Surry	40	SR 2142	Pine Ridge Trail	NC 268	CUL-DE-SAC	0.00	0.38	2	2	2WU	0.38	20	4,459		2,452			49	
2022CPT.11.21.20862	Surry	41	SR 2143	High Oak Ct	SR 2142	CUL-DE-SAC	0.00	0.05	2	2	2WU	0.05	19	557		307			7	
2022CPT.11.21.20862	Surry	42	SR 2147	Parkview Cir	NC 268	SR 2147	0.00	0.40	2	2	2WU	0.40	20	4,693		2,581			52	
2022CPT.11.21.20862	Surry	43	SR 2200	Simpson Mill Rd	SR 1100	MP 7.0	4.22	7.00	1	2	2WU	2.78	18		29,357	23,192			361	
2022CPT.11.21.20862	Surry	44	SR 2208	Greene Rd	NC 268	SR 1003	0.00	1.27	1	2	2WU	1.27	18		13,411	10,595			165	
2022CPT.11.21.20862	Surry	45	SR 2284	Westwind Ct	SR 2118	CUL-DE-SAC	0.00	0.24	2	2	2WU	0.24	18	2,534		1,394			31	
2022CPT.11.21.20862	Surry	46	SR 2285	Windgate Ct	SR 2118	DE	0.00	0.19	2	2	2WU	0.19	20	2,229		1,226			25	
2022CPT.11.21.20862	Surry	47	SR 2287	Eastwind Ct	SR 2218	CUL-DE-SAC	0.00	0.17	2	2	2WU	0.17	16	1,596		878			22	
2022CPT.11.21.20862	Surry	47A	SR 1830	Matthews Rd	SR 1809	SR 1815	0.00	2.16	2	2	2WU	2.16	18	22,810		12,545			281	
TOTAL FOR PROJECT NO. 2022CPT.11.21.20862												21.89		87,572	151,184	167,600		2,846		
2022CPT.11.21.20992	Yadkin	48	SR 1139	Hayfield Rd	SR 1314	CUL-DE-SAC	0.00	0.85	1	2	2WU	0.85	20		9,973	7,879			111	
2022CPT.11.21.20992	Yadkin	49	SR 1191	Ollie Couch Rd	SR 1103	END PVMT	0.00	0.39	1	2	2WU	0.39	18		4,118	3,254			51	
2022CPT.11.21.20992	Yadkin	50	SR 1345	Wagoner Rd	SR 1349	US 21	0.00	2.34	1	2	2WU	2.34	20		27,456	21,690			304	
2022CPT.11.21.20992	Yadkin	51	SR 1434	Carrie Farm Rd	SR 1316	EOP	0.00	0.17	1	2	2WU	0.17	18		1,742	1,376			21	
2022CPT.11.21.20992	Yadkin	52	SR 1531	Roberts Rock rd	SR 1529	EOM	0.00	0.50	1	2	2WU	0.50	18		5,280	4,171			65	
2022CPT.11.21.20992	Yadkin	53	SR 1566	Taylor Rd	SR 1549	SR 1605	0.00	2.08	1	2	2WU	2.08	18		21,986	17,369			271	
2022CPT.11.21.20992	Yadkin	54	SR 1596	Moccasin Gap Rd	SR 1584	PVMT Width Change	0.00	0.77	1	2	2WU	0.77	20		9,035	7,137			100	
2022CPT.11.21.20992	Yadkin	55	SR 1596	Moccasin Gap Rd	PVMT Width Change	SR 1570	0.77	1.70	1	2	2WU	0.93	18		9,821	7,758			121	
2022CPT.11.21.20992	Yadkin	56	SR 1637	Village Dr	SR 1600	SR 1605	0.00	0.32	2	2	2WU	0.32	18	3,379		2,670			42	
2022CPT.11.21.20992	Yadkin	57	SR 1639	Stone Ridge Dr	SR 1566	EOM/Cul De Sac	0.00	0.46	2	2	2WU	0.46	18	4,858		2,672			60	
2022CPT.11.21.20992	Yadkin	58	SR 1643	Glenn Ferry Rd	SR 1566	EOM/Cul De Sac	0.00	0.24	2	2	2WU	0.24	18	2,534		1,394			31	
2022CPT.11.21.20992	Yadkin	59	SR 1664	Jordan's Gate Dr	SR 1566	EOM/Cul De Sac	0.00	0.17	2	2	2WU	0.17	18	1,795		987			22	
TOTAL FOR PROJECT NO. 2022CPT.11.21.20992												9.22		12,566	89,412	78,358		1,198		
GRAND TOTAL												45.39		100,138	388,696	362,957	5	500	5,901	1

8/17/99

PROJECT REFERENCE NO.	SHEET NO.
2022CPT.JI.21.20032 2022CPT.JI.21.20862 2022CPT.JI.21.20992	

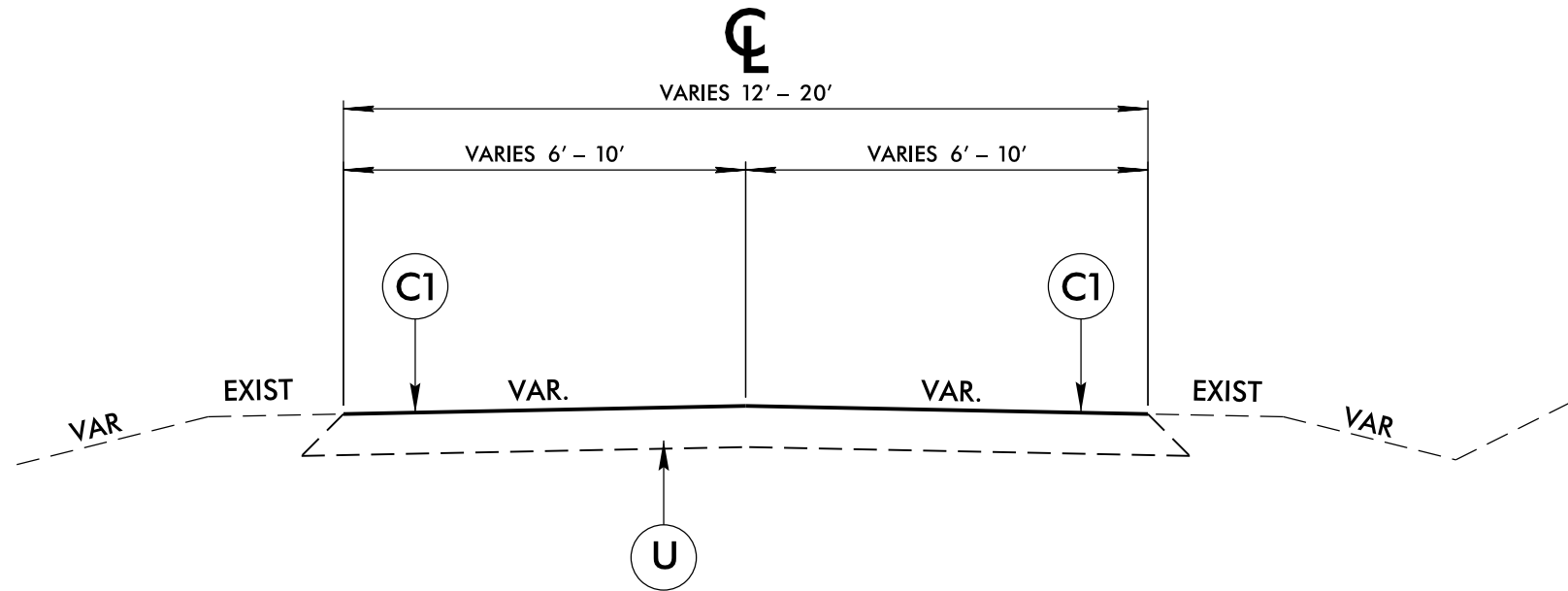

TYPICAL SECTION NO. 1

MAPS 1 - 18, 20, 21, 25, 28 - 32, 43, 44, 48 - 55

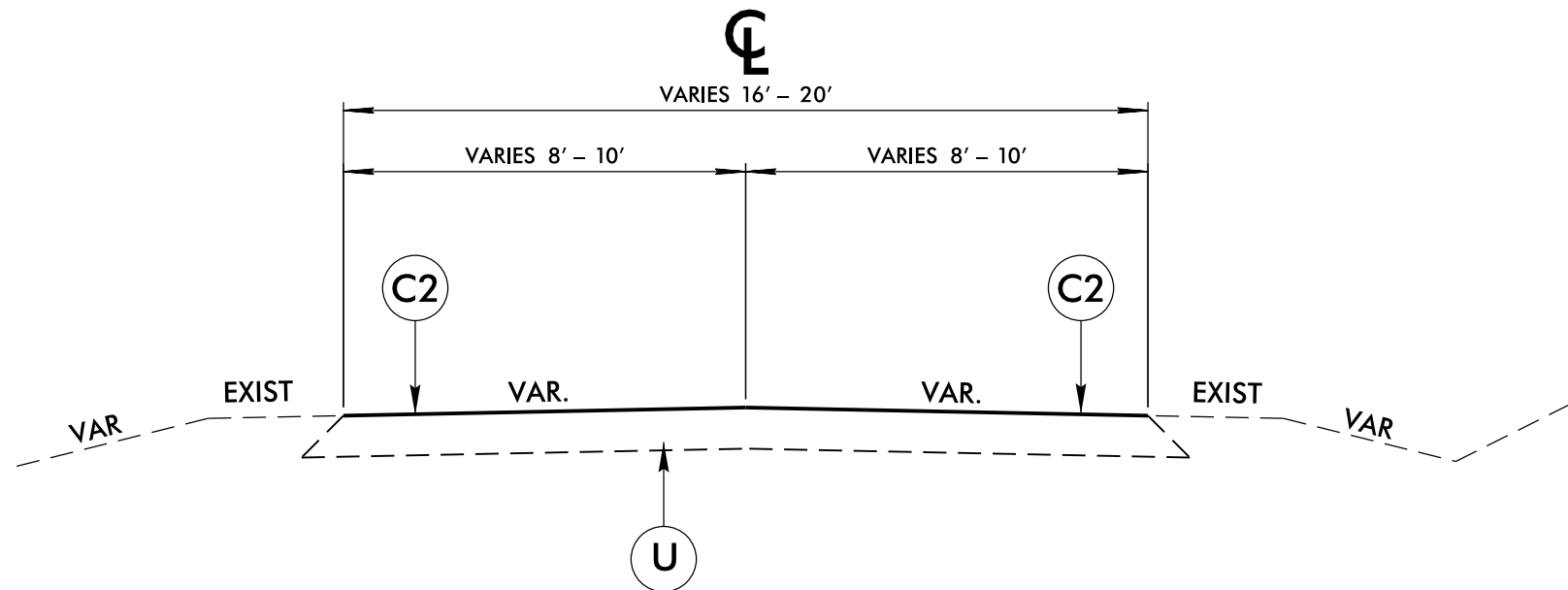

TYPICAL SECTION NO. 2

MAPS 19, 22 - 24, 26, 27, 33 - 42, 45 - 47, 47A, 56 - 59

PAVEMENT SCHEDULE	
C1	PROP. ASPHALT SURFACE TREATMENT, TRIPLE SEAL
C2	PROP. ASPHALT SURFACE TREATMENT, CAPE SEAL
U	EXISTING PAVEMENT

DIVISION II DISTRICT 1 COUNTIES ASPHALT SURFACE TREATMENT RESURFACING		
DIVISION II		
REVISIONS	INT.	DATE
N.C. DEPARTMENT of TRANSPORTATION DIVISION of HIGHWAYS DIVISION ELEVEN		



SCALE: N/A DATE: 08/18/2021

PREPARED BY: GK

REVIEWED BY:

REVIEWED BY:

STATE OF NORTH CAROLINA
DIVISION OF HIGHWAYS

ALLEGHANY COUNTY

TYPE OF WORK: AST - SECONDARY ROUTES

2022

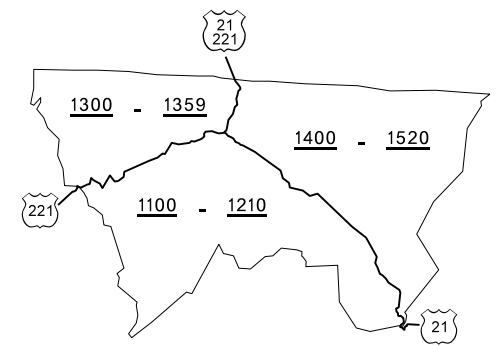
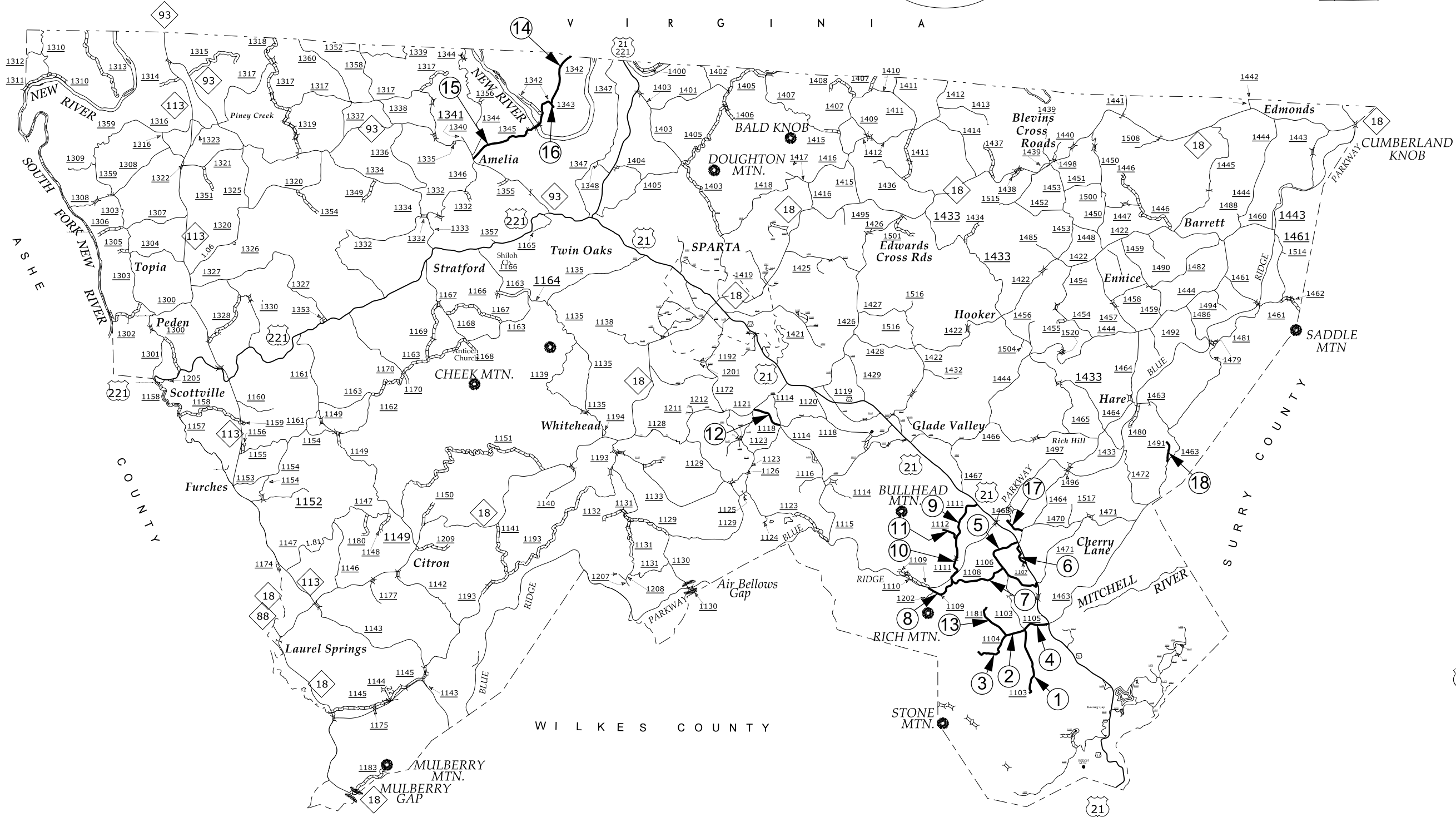
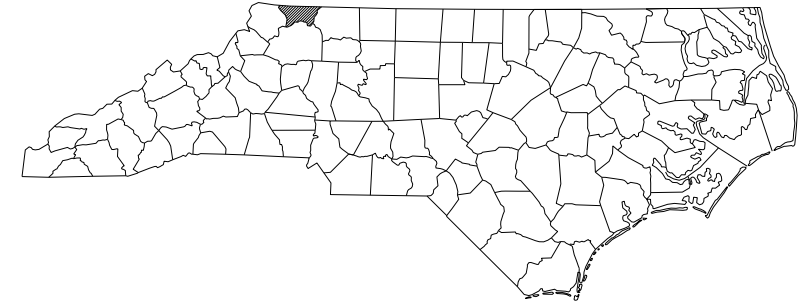

KEY TO COUNTY ROAD NUMBERS

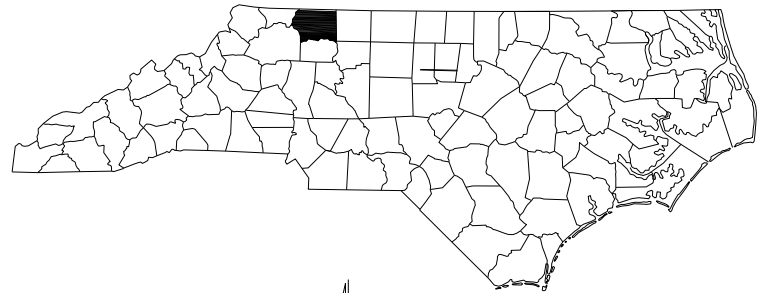

STATE OF NORTH CAROLINA
DIVISION OF HIGHWAYS

SURRY COUNTY

TYPE OF WORK: AST - SECONDARY ROUTES

2022

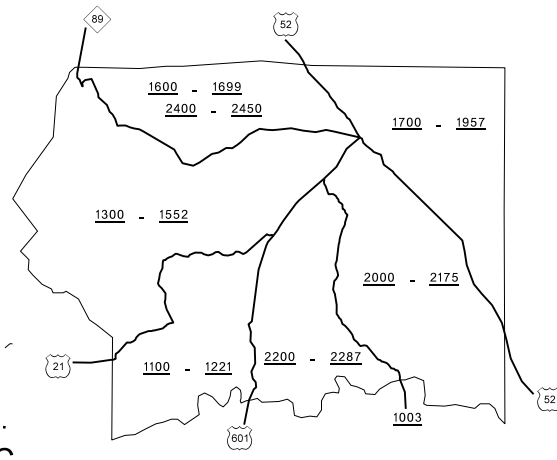
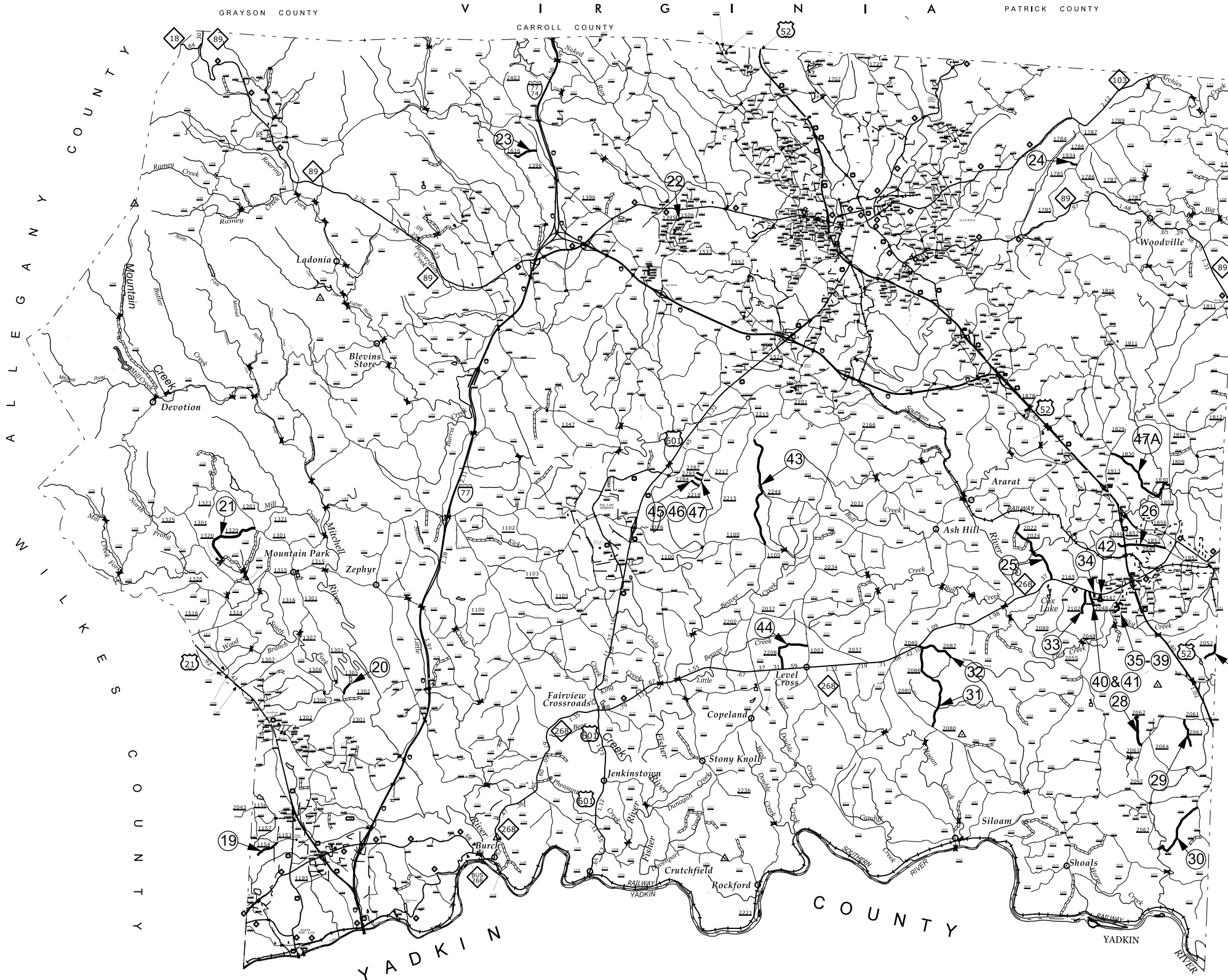

KEY TO COUNTY ROAD NUMBERS

VA.
N.C.

STOKES
COUNTY

FORSYTH CO.

YADKIN COUNTY

TYPE OF WORK: AST - SECONDARY ROUTES

2022

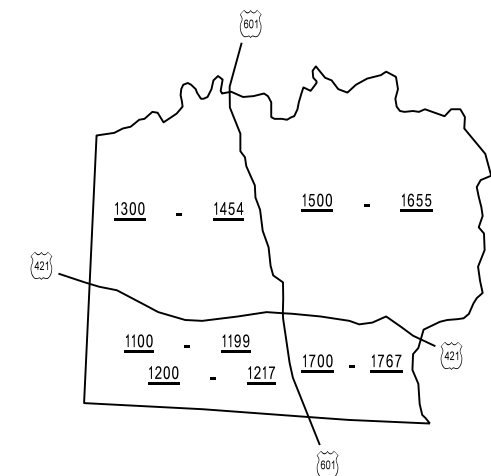
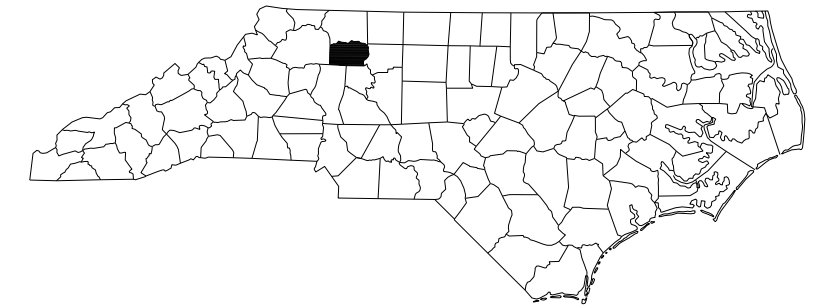
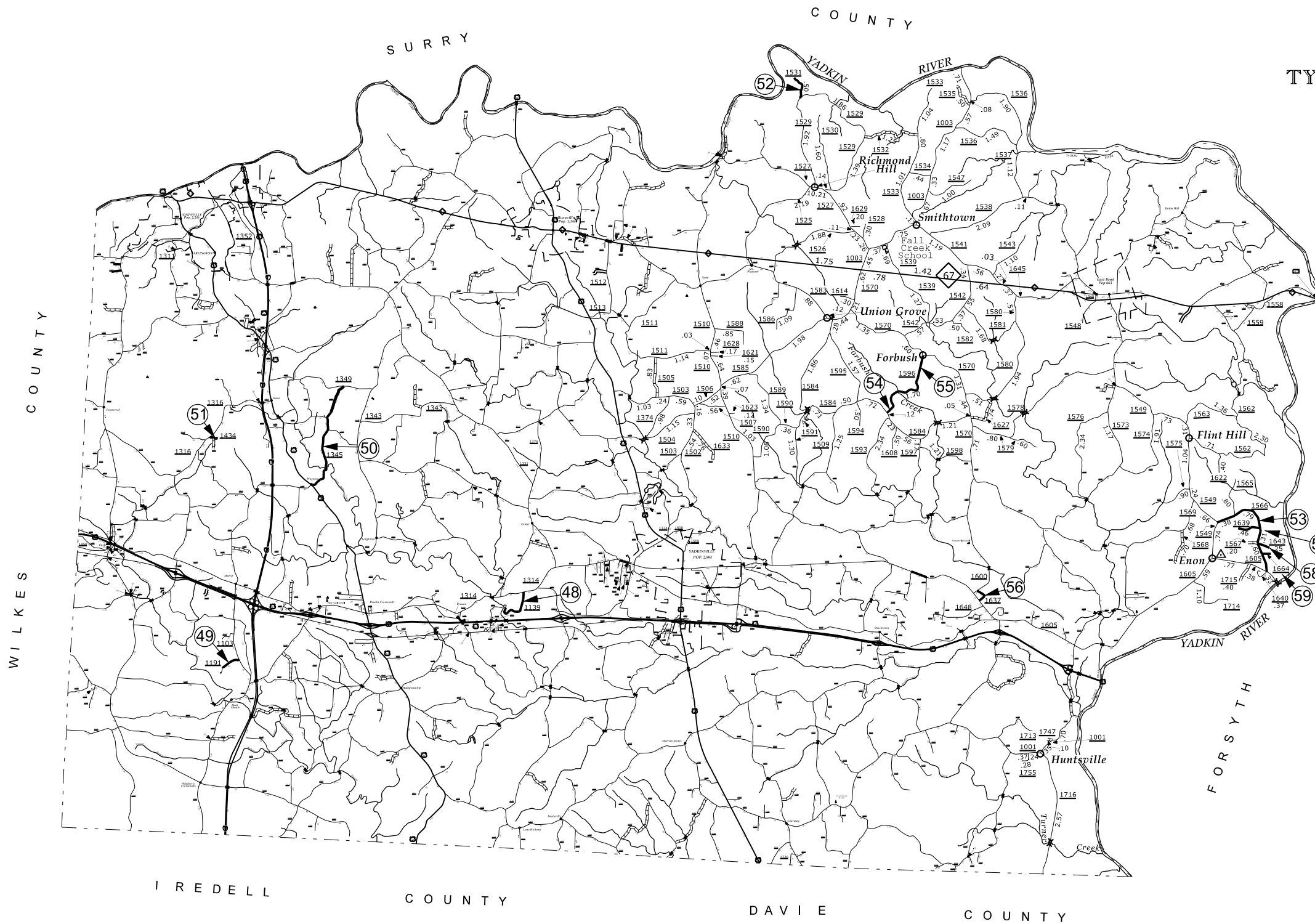

KEY TO COUNTY ROAD NUMBERS

SIGNING FOR ASPHALT SURFACE TREATMENT

LEGEND

- ▷ PORTABLE SIGN
- └ STATIONARY SIGN
- ← DIRECTION OF TRAFFIC FLOW

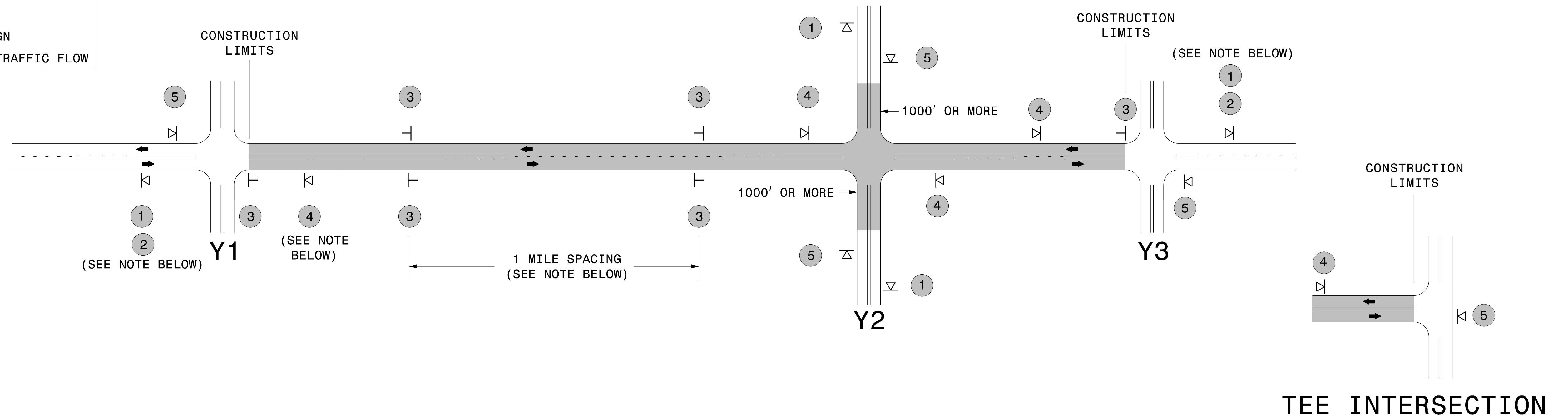

MAINLINE (-L-) SIGNING

-Y- LINE SIGNING

SIGNING NOTES AND PLACEMENT PER DIRECTION		<ul style="list-style-type: none"> - PLACE 1000' PRIOR TO BEGINNING OF CONSTRUCTION LIMITS. ONLY USED ON -Y- LINES IF RESURFACING LIMITS EXTEND 1000' ALONG -Y- LINE. - SIGN #2 ONLY USED WHEN RESURFACING LIMITS ARE 2 OR MORE MILES IN LENGTH. ROUND UP TO THE NEAREST WHOLE NUMBER. DO NOT USE FRACTIONAL OR DECIMAL NUMBERS. 	<p>STATIONARY SIGNING NOT REQUIRED FOR THE FOLLOWING -Y- LINE CONDITIONS:</p> <ol style="list-style-type: none"> 1) LESS THAN 1000' OF RESURFACING ALONG -Y- LINE 2) SUBDIVISION ROADS 3) DEAD END ROADS <p>WHEN PAVING/CONSTRUCTION ACTIVITIES PROCEED ACROSS AN UNSIGNED -Y- LINE, PORTABLE ADVANCE WARNING SIGNS SHALL BE USED ALONG THE -Y- LINE AS SHOWN BELOW. REMOVE UPON COMPLETION OF WORK.</p> <div style="display: flex; justify-content: space-around; align-items: center;"> <div style="text-align: center;"> <p>PLACED 500' IN ADVANCE OF FLAGGER.</p> </div> <div style="text-align: center;"> <p>PLACED 250' IN ADVANCE OF FLAGGER.</p> </div> </div>
		<ul style="list-style-type: none"> - ALTERNATE THE FOLLOWING TWO SIGNS: - STARTING WITH "LOOSE GRAVEL" (W8-7) FOLLOWED BY "UNMARKED PAVEMENT". - PLACE INITIALLY AT THE CONSTRUCTION LIMITS AND SPACED 1 MILE APART THEREAFTER. - AT TEE INTERSECTIONS INSTALL INITIALLY 0.5 MILE FROM INTERSECTION AND SPACE 1 MILE APART THEREAFTER. 	
		<ul style="list-style-type: none"> - THESE ARE FOR -Y- LINES THAT ARE "THROUGH" ROADWAYS. DEAD END AND SUBDIVISION ROADS ARE NOT "THROUGH" ROADWAYS. - INSTALL 500' +/- FROM EACH -Y- LINE APPROACH AS SHOWN ABOVE. - FOR MULTIPLE -Y- LINES THAT ARE SEPARATED BY 0.25 MILES OR LESS, TREAT AS A SINGLE UNIT AND INSTALL WITHIN 500' OF EACH APPROACH. - A MAXIMUM OF 2 SIGN SETS PER MILE. DO NOT INSTALL WHEN -Y- LINES ARE WITHIN 0.5 MILES FROM "END ROAD WORK" SIGN. 	
		<ul style="list-style-type: none"> - PLACE 500' FOLLOWING THE END OF CONSTRUCTION LIMITS OR AS SHOWN WHEN WORK ENDS AT A 3-WAY TEE INTERSECTION. 	
	<p>THE ABOVE SIGNS ARE ALL THAT ARE REQUIRED FOR A CONTRACTOR TO BEGIN A RESURFACING CONTRACT. ANY ADDITIONAL SIGNS REQUESTED BY NCDOT DIVISIONS SHALL BE INSTALLED WITHIN 7 BUSINESS DAYS OF THE START OF CONTRACT WORK.</p>		

MAPS LESS THAN 2 MILES

FOR AST RESURFACING MAPS WITH CONSTRUCTION LIMITS LESS THAN 2 MILES IN LENGTH, USE A STATIONARY "LOOSE GRAVEL" SIGN AT THE BEGINNING CONSTRUCTION LIMIT FOLLOWED BY AN "UNMARKED PAVEMENT" SIGN MIDWAY THROUGH AND AN "END ROAD WORK" SIGN AT THE END CONSTRUCTION LIMIT.

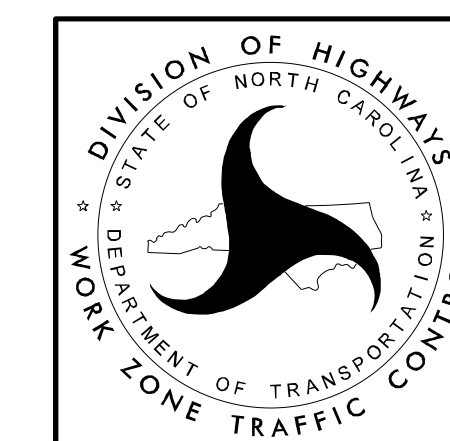

ADVANCE WARNING SIGNS FOR 2-LANE ROADWAY ASPHALT SURFACE TREATMENT